

NYS TAX MAPS 89071302

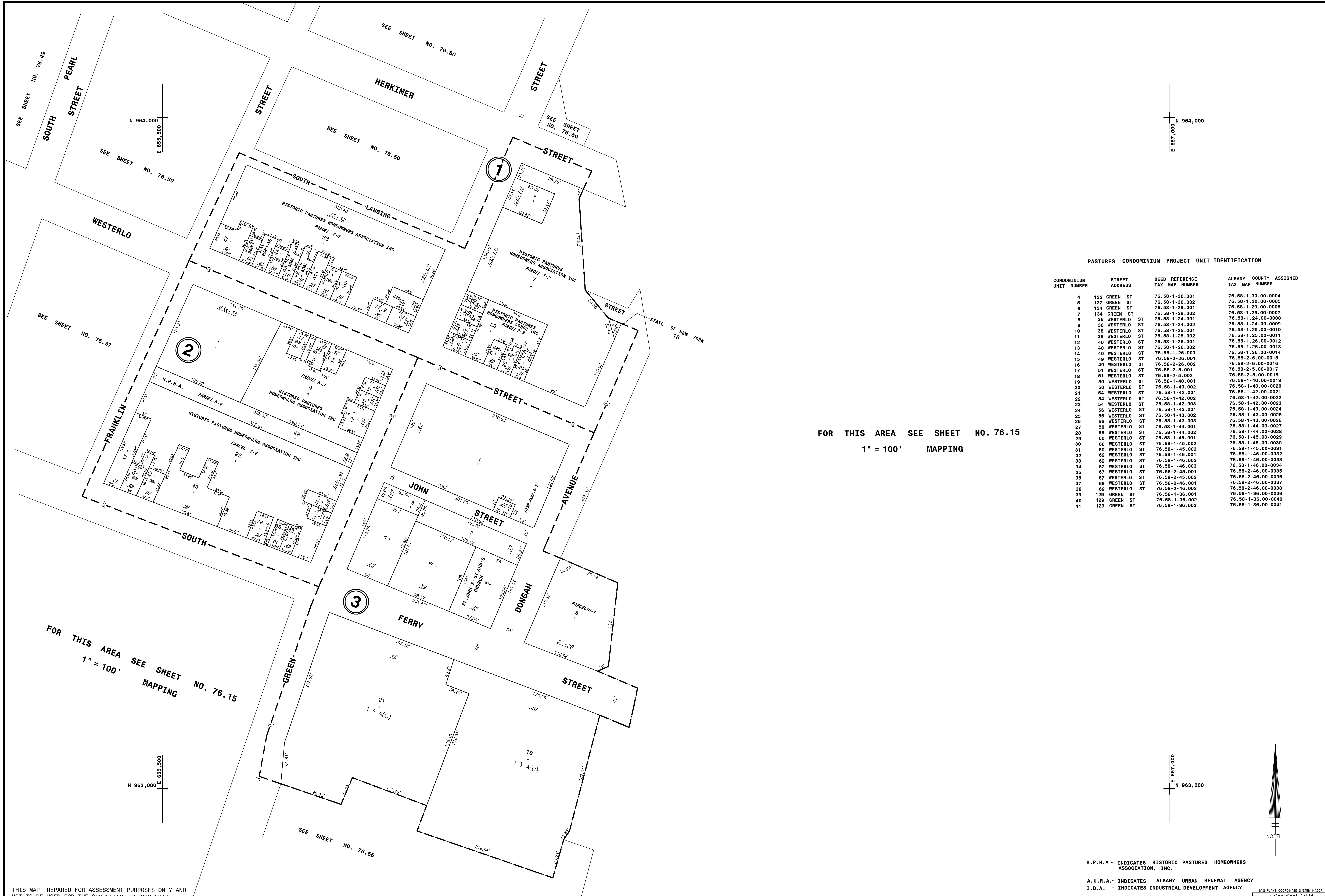

PASTURES CONDOMINIUM PROJECT UNIT IDENTIFICATION

Table with columns: CONDOMINIUM UNIT NUMBER, STREET ADDRESS, DEED REFERENCE TAX MAP NUMBER, ALBANY COUNTY ASSIGNED TAX MAP NUMBER. Lists units 4 through 41.

FOR THIS AREA SEE SHEET NO. 76.15
1" = 100' MAPPING

FOR THIS AREA SEE SHEET NO. 76.15
1" = 100' MAPPING

THIS MAP PREPARED FOR ASSESSMENT PURPOSES ONLY AND NOT TO BE USED FOR THE CONVEYANCE OF PROPERTY

H.P.H.A - INDICATES HISTORIC PASTURES HOMEOWNERS ASSOCIATION, INC.

A.U.R.A. - INDICATES ALBANY URBAN RENEWAL AGENCY
I.D.A. - INDICATES INDUSTRIAL DEVELOPMENT AGENCY

NYS PLANE COORDINATE SYSTEM NAD83
© Copyright 2024
County of Albany, NY, USA

AUTHORIZED BY: ORDINANCE OF THE COMMON COUNCIL PASSED AUGUST 21, 1972
PREPARED BY: SMITH & MAHONEY, CONSULTING ENGINEERS ALBANY, NEW YORK

DIGITAL CONVERSION BY: THE SANBORN MAP COMPANY INC. PELHAM, NEW YORK

REVISION TABLE with columns: DATE, MADE BY, CHANGES OR ADDITIONS

REVISION TABLE with columns: DATE, MADE BY, CHANGES OR ADDITIONS

REVISION TABLE with columns: DATE, MADE BY, CHANGES OR ADDITIONS

LEGEND with columns: PROPERTY LINE, CITY LINE, FIRE DISTRICT LINE, etc.

Sheet Index table showing map numbers 76.49, 76.50, 76.12, 76.57, 76.66.

TAX MAP 76.58 CITY OF ALBANY ALBANY COUNTY, NEW YORK