

NYS ZONING & PLANNING, 8/21/10

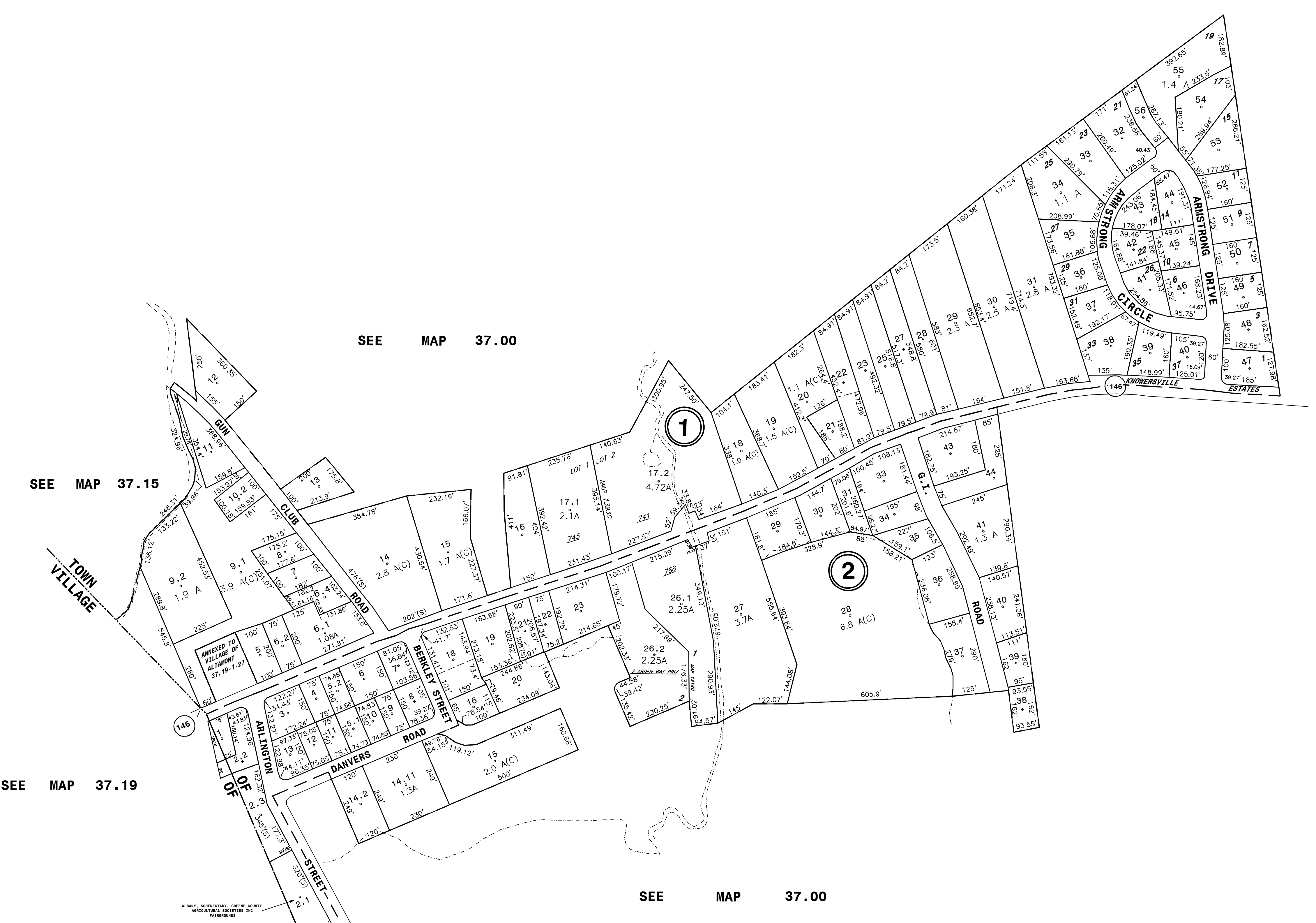
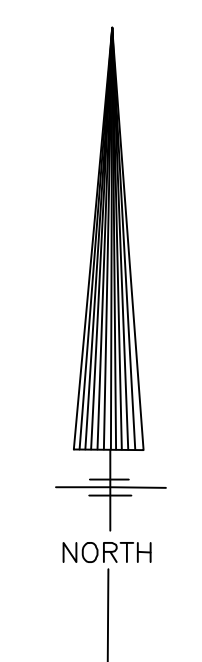
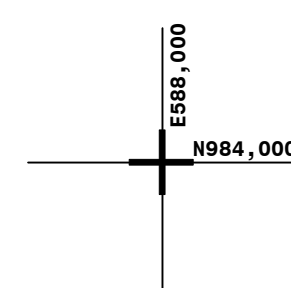
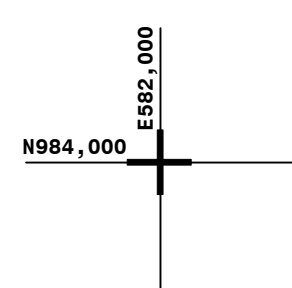
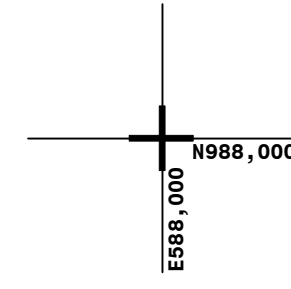
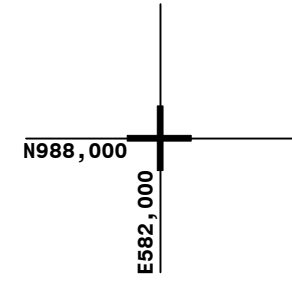

THIS MAP PREPARED FOR ASSESSMENT PURPOSES ONLY AND NOT TO BE USED FOR THE CONVEYANCE OF PROPERTY

PREPARED BY SMITH & MAHONEY, ENGINEERS & SURVEYORS ALBANY, NEW YORK REAL PROPERTY TAX SERVICE AGENCY ALBANY COUNTY, NEW YORK

DIGITAL CONVERSION BY: THE SANBORN MAP COMPANY INC. PELHAM, NEW YORK

REVISION TABLE with columns for DATE, BY, CHANGES OR ADDITIONS, and a detailed list of revisions.

SPECIAL DISTRICTS table with columns for TYPE, SYMBOL, DISTRICT NAME, and DISTRICT NAME.

LEGEND table with columns for CITY LINE, VILLAGE LINE, TOWN LINE, BLOCK LIMIT, GREAT LOT LINE, EASEMENT LINE, WATER DISTRICT LINE, and symbols for various lines.

PROPERTY LINE table with columns for PROPERTY LINE, ORIGINAL LOT LINE, RAIL ROAD, STREAM OR DITCH, ROAD OR RAIL ROAD BNDY., STREET CENTERLINE, COUNTY LINE, and symbols for various lines.

TAX DISTRICT LINE table with columns for TAX DISTRICT LINE, FIRE DISTRICT LINE, DENOTES COMMON OWNER, TAX MAP BLOCK NO., TAX MAP PARCEL NO., STREET NUMBER, FILED PLAN LOT NO., and symbols for various lines.

Town of Guilderland, Albany County, New York. Includes tax map block number 74.12-1-10, sheet index, scale 1"=200', and date 3/1/24.